

| | | | |
|--------------|---------|----------|---------|
| PROJECT NAME | JOB NO. | QUANTITY | ITEM NO |
|--------------|---------|----------|---------|

Air screen back wall case

MODEL **SWINA**



Backwall airscreen case Model SWINA with custom base and countertop.

General Information

Air screen back wall refrigerated cases offer space-saving back-wall design with extra dry storage and convenient customer counter space. Perfect for displaying self-serve cold beverages, fresh fruit and chilled prepackaged items, all without customer-side doors.

Air curtain technology allows better visibility, easy selection and loading, and eliminates maintenance problems with worn-out or ill-fitting doors.

Refcon air screen cases are attractive, quiet, and built from tough, easy-to-clean stainless steel and laminates. Standard 3500K interior lighting offers a bright, attention-getting display. Electronic temperature and defrost control and digital temperature display for energy efficient operation.

Available with self-contained or remote refrigeration. Leveling legs are standard. Choose from 4 lengths up to 12 ft (3.7m).

See below for available options, including rear loading doors, additional air flow patterns, and a choice of security door designs.

Standard Features

- Stainless steel interior
- Mirror ends.
- (3) adjustable lighted 12 in. (30 cm) shelves.
- Standard grade plastic laminate exterior (matte finish).
- 3500K fluorescent tube lights.
- Condensate evaporator (self-contained units).
- Digital temperature display.
- Electronic temperature and defrost control (self-contained units).
- Dry bottom storage.

Options

- Glass ends
- Stainless steel exterior
- 4 in. exhaust wall standoffs
- Black powder painted interior
- White powder painted interior
- Custom powder painted interior
- Remote refrigeration control package
- One way mirror rear load door
 - Rear door locks
- Additional shelves with lights
- LED lighting
- Pull down plastic energy shade
- Sound reduction package
- Refrigerated bottom storage – Remote cases only (call for BTU requirements)
- 10" Height extension for self-service section (88" overall height)

- Power cord and plug
- 1-year labor warranty
- 5-year compressor warranty
- Choice of alternative air flow patterns—see air screen airflow options sheet for details.

Security Options

- Pocket security doors
- Roll down security shutter
- Removable Lexan® security panels

Designed to operate in air conditioned space maintained at 75°F (24°C) and 55% relative humidity. Continuing product improvement may subject specifications to change without notice.

| | |
|-----------------------------------|--------------------------------------------|
| CUSTOMER NAME | |
| <input type="checkbox"/> APPROVED | <input type="checkbox"/> APPROVED AS NOTED |
| <input type="checkbox"/> RESUBMIT | |
| AUTHORIZED SIGNATURE | DATE |



Refcon Inc.
 335 Chestnut Street Norwood, NJ 07648 USA
 Tel: (201) 750-5060
 Fax: (201) 750-5066
 e-mail: sales@refconcase.com
REFCON™ www.refconcase.com

Air screen back wall case

MODEL **SWINA**

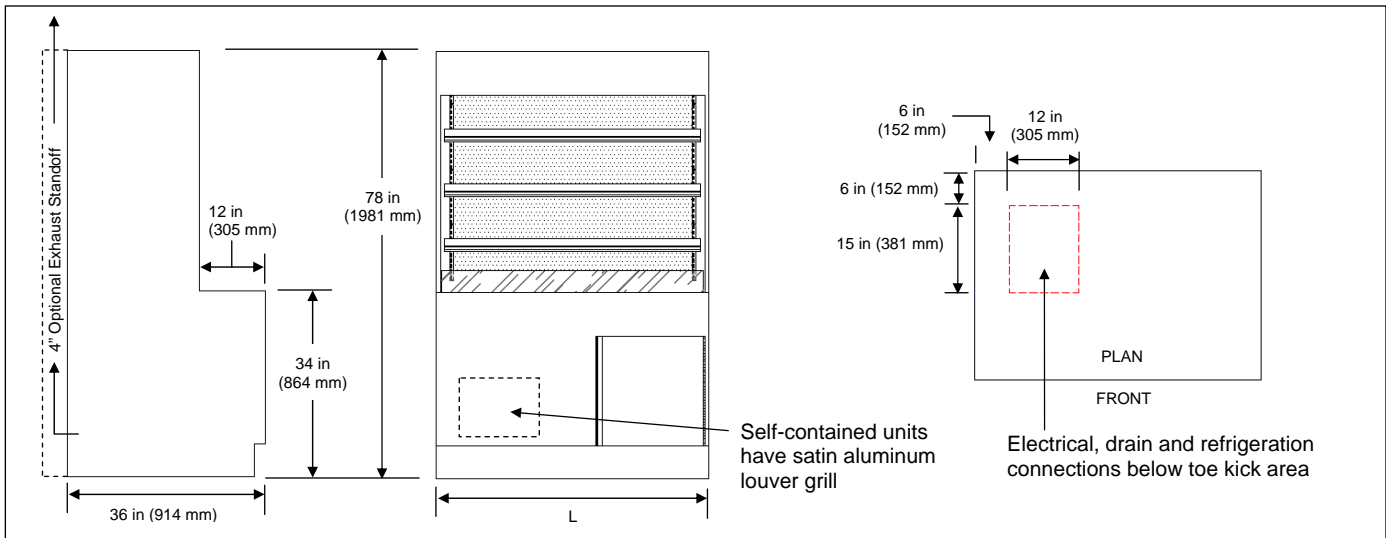

| | Model | Dimensions | | Refrigeration requirements | Crated Weight | |
|-------------------------------------|-----------|-------------------|-------------------|----------------------------|---------------|-----|
| | | (L x D x H) in | (L x D x H) mm | | lb | kg |
| Self-contained Refrigeration | SWINAS048 | 49 1/2 x 36 x 78 | 1257 x 914 x 1981 | 3/4 HP | 600 | 272 |
| | SWINAS072 | 73 1/2 x 36 x 78 | 1867 x 914 x 1981 | 1 HP | 900 | 407 |
| | SWINAS096 | 97 1/2 x 36 x 78 | 2477 x 914 x 1981 | 1 1/2 HP | 1200 | 545 |
| Remote Refrigeration (R404a) | SWINAR048 | 49 1/2 x 36 x 78 | 1257 x 914 x 1981 | 4800 @ +15 | 500 | 227 |
| | SWINAR072 | 73 1/2 x 36 x 78 | 1867 x 914 x 1981 | 7200 @ +15 | 700 | 318 |
| | SWINAR096 | 97 1/2 x 36 x 78 | 2477 x 914 x 1981 | 9600 @ +15 | 900 | 407 |
| | SWINAR144 | 145 1/2 x 36 x 78 | 3696 x 914 x 1981 | 14400 @ +15 | 1300 | 590 |

Laboratory certifications



Electrical

| | Model | Volts | Phase | Cycle/Hz | Watts | MCA | Plug type (optional) |
|-------------------------------------|-----------|---------|-------|----------|-------|-----|----------------------|
| Self-contained Refrigeration | SWINAS048 | 120-208 | 1 | 60 | 2655 | 18 | NEMA L14-20P |
| | SWINAS072 | 120-208 | 1 | 60 | 3385 | 23 | NEMA L14-30P |
| | SWINAS096 | 120-208 | 1 | 60 | 4639 | 31 | NEMA 14-50P |
| Remote Refrigeration (R404a) | SWINAR048 | 120 | 1 | 60 | 360 | 3 | NEMA 5-15P |
| | SWINAR072 | 120 | 1 | 60 | 600 | 5 | |
| | SWINAR096 | 120 | 1 | 60 | 720 | 6 | |
| | SWINAR144 | 120 | 1 | 60 | 1200 | 10 | |

NOTE: 1) Floor drain required for remote units. 2) See air screen airflow options sheet. 3) Black laminate at top and rear.

Please specify exterior finish:



Refcon Inc.

Tel: (201) 750-5060
www.refconcase.com