

PROJECT NAME	JOB NO.	QUANTITY	ITEM NO
--------------	---------	----------	---------

Deli Eclipse

MODEL **LECLD**



Deli Eclipse refrigerated serving counter

General Information

With its exciting lines and distinctive wide-window display, Refcon's Eclipse refrigerated serving counters delivers a dramatic, visually exciting presentation for your cold deli offerings.

Employees will appreciate the Eclipse, too, for its easy access for serving, restocking or cleaning.

Large, curved, lift-up glass panels maximize visibility and draw customers to do more than window shop. Eclipse's smooth lines combine the ultimate in service and self-service operations.

Refcon refrigerated serving counters are built from tough, easy-to-clean laminates and stainless steel. 3500K interior lighting offers a bright, attention-getting display. Electronic controls and digital temperature display makes it easy to keep products cold while using energy efficiently.

A wide choice of options are available to help you customize your Refcon Eclipse, including glass or mirror ends and lower front decorative lighting. Cases can also be designed for a continuous case line up.

Standard Features

- Lift-up curved glass.
- Interior stainless steel deck and rear plenum.
- Exterior standard grade plastic laminate (matte finish).
- 3500K fluorescent lights.
- Digital temperature display.
- Remote refrigeration (R404a)

Options

- Stainless steel exterior
- Black interior
- Glass ends
- One-way mirror ends
- Tiered display insert
 - 1 step for 2-level display
 - 2 steps for 3-level display
- Scale platform
- 18 in. (457 mm) paper roll holder
- Front cart bumper
- Rear flip-up cutting board
- Lower front decorative lighting
- LED lighting
- Continuous case line up
- Remote refrigeration temperature control package
- GFI convenience outlet 15A (to J box)
- Power cord and plug

Designed to operate in air conditioned space maintained at 75°F (24°C) and 55% relative humidity. Continuing product improvement may subject specifications to change without notice.

CUSTOMER NAME	
<input type="checkbox"/> APPROVED	<input type="checkbox"/> APPROVED AS NOTED
<input type="checkbox"/> RESUBMIT	
AUTHORIZED SIGNATURE	DATE



Refcon Inc.
 335 Chestnut Street Norwood, NJ 07648 USA
 Tel: (201) 750-5060
 Fax: (201) 750-5066
 e-mail: sales@refconcase.com
REFCON™ www.refconcase.com

PROJECT

ITEM NO

Deli Eclipse

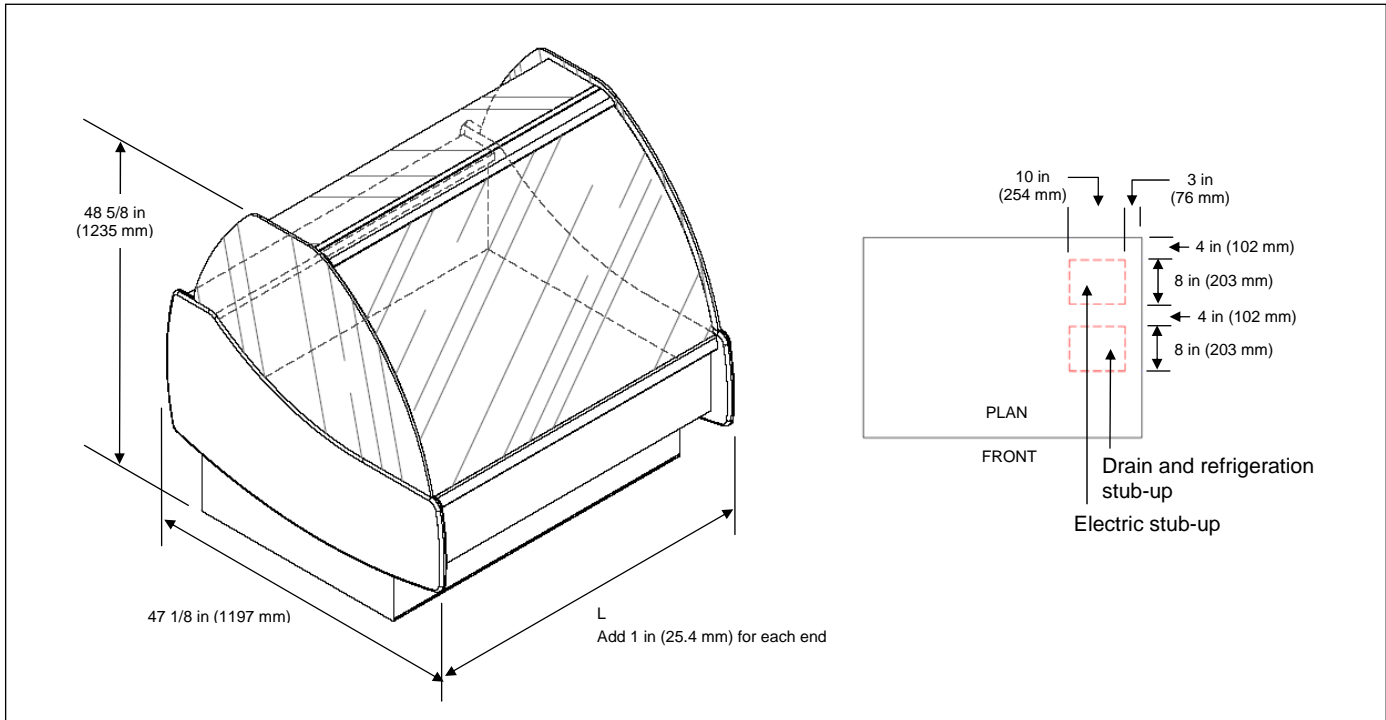
MODEL **LECLD**

Model	Dimensions		Refrigeration requirements	Crated Weight	
	(L x D x H) in	(L x D x H) mm		lb	kg
LECLDR036	36 x 47 1/8 x 48 5/8	914 x 1197 x 1235	1500 @ +15	780	354
LECLDR048	48 x 47 1/8 x 48 5/8	1219 x 1197 x 1235	2000 @ +15	845	384
LECLDR072	72 x 47 1/8 x 48 5/8	1829 x 1197 x 1235	3000 @ +15	960	436
LECLDR096	96 x 47 1/8 x 48 5/8	2438 x 1197 x 1235	4000 @ +15	1100	499

Laboratory certifications



Note: Add 1 in (25.4 mm) to L dimension for each end.

Electrical

Model	Volts	Phase	Cycle/Hz	Watts	Amps	Plug type (optional)
LECLDR036	120	1	60	240	2.0	NEMA 5-15P 
LECLDR048	120	1	60	240	2.0	
LECLDR072	120	1	60	240	2.0	
LECLDR096	120	1	60	240	3.0	

NOTE: Floor drain required.

Please specify exterior finish:



Refcon Inc.

Tel: (201) 750-5060
www.refconcase.com